

LOCAL
East
University



Service Monday – Friday
No Holiday service
CHECK RIDEDART.COM FOR
HOLIDAY SERVICE INFORMATION.
Platform M

- Route Destinations**
- ▶ Pleasant Hill Park and Rides
 - ▶ Iowa State Fairgrounds
 - ▶ Broadlawns East University Clinic
 - ▶ Downtown
 - ▶ DART Central Station

Pass Sales Outlets

Price Chopper

- 3425 Ingersoll Ave.: Rt. 11, 60
- 1819 Beaver Ave.: Rt. 5
- 4343 Merle Hay Rd.: Rt. 5, 14, 16, 50
- 5440 NW 86th St., Johnston: Rt. 93

Cash Saver

- 4121 Fleur Dr.: Rt. 8
- 1320 E. Euclid Ave.: Rt. 4, 50

DART Administrative Offices

620 Cherry St.: All Local Routes

E-Z Money Check Cashing

- 2910 E. University Ave.: Rt. 1, 10
- 1238 E. 14th St.: Rt. 4, 10, 17
- 904 Army Post Rd.: Rt. 7

Hy-Vee Drugstore

42nd & University Ave.: Rt. 3, 60

Hy-Vee Food Stores

- 3330 Martin Luther King Jr. Pkwy.: Rt. 16
- 2540 E. Euclid Ave.: Rt. 17, 50
- 3221 SE 14th St.: Rt. 6
- 4707 Fleur Dr.: Rt. 8
- 1107 E. Army Post Rd.: Rt. 6, 7
- 8601 Douglas Ave., Urbandale: Rt. 93, 73
- 1700 Valley West Dr., West Des Moines:
Rt. 3, 52, 72, 94
- 1990 Grand Ave., West Des Moines: Rt. 96
- 555 S. 51st St., West Des Moines: Rt. 52, 96
- 1725 Jordan Creek Pkwy., West Des Moines*:
Rt. 52, 94, 95, 72
- 7101 University Ave., Windsor Heights: Rt. 3
- 100 8th St. SW, Albona: Rt. 99
- 4815 Maple Dr., Pleasant Hill: Rt. 10
- 410 N. Ankeny Blvd., Ankeny: Rt. 98
- 2510 SW State St., Ankeny: Rt. 98

Walmart

- 1002 SE National Dr., Ankeny*: Rt. 98
- 1001 73rd St., Windsor Heights*: Rt. 3, 76

Routes are listed next to the Pass Sales Outlet locations they service. Next nearest route(s) are also listed.

* Locations where tokens are not available.

^ Only Express Plus passes.

+ Passes only for Monthly, HalfFare Monthly, and Monthly Express Plus (no tokens or weekly).

Fares

Local Routes

Adult.....	\$ 1.75
HalfFare *.....	.75
Children 6 – 10.....	.75
Children 5 and under.....	FREE
<i>(Must be accompanied by an adult)</i>	

Express Routes

Cash.....	\$ 2.00
HalfFare*.....	.75

Tokens

Tokens must be purchased in packages of 10.

Full Fare.....	10/\$ 17.50
HalfFare (Reduced Fare ID*).....	10/\$ 7.50

Passes

Monday – Friday	
6 a.m. – 11 p.m.	
Saturday	
6 a.m. – 10 p.m.	
Sunday	
7 a.m. – 6 p.m.	

Customer Service Window Hours

- Monday – Friday
6:30 a.m. – 7 p.m.
- Saturday & Sunday
8 a.m. – 4 p.m.

Customer Service Phone Hours

- Monday – Friday
6 a.m. – 7 p.m.
- Saturday & Sunday
8 a.m. – 4 p.m.

Local Routes

Adult.....	\$ 1.75
HalfFare *.....	.75
Children 6 – 10.....	.75
Children 5 and under.....	FREE
<i>(Must be accompanied by an adult)</i>	

Express Routes

Cash.....	\$ 2.00
HalfFare*.....	.75

Tokens

Tokens must be purchased in packages of 10.

Full Fare.....	10/\$ 17.50
HalfFare (Reduced Fare ID*).....	10/\$ 7.50

Passes

Day Pass (Local, Express).....	\$ 4.00
Half Fare Day Pass (Local, Express)*.....	\$ 2.00
Weekly (Local).....	\$ 16.00
HalfFare Weekly**.....	\$ 7.00
Local Express & Flex/On Call).....	
Monthly (Local).....	\$ 48.00
HalfFare Monthly**.....	\$ 24.00
Local Express & Flex/On Call).....	
Monthly Express Plus.....	\$ 58.00
Local, Express & Flex/On Call).....	
Flex/On Call Service	
Cash.....	\$ 3.50
HalfFare *.....	.75

Veterans Ride Free

Thanks to a partnership with Polk County Veterans Affairs, veterans can ride local, Express, Flex and On Call service for free when they show a photo ID indicating veteran status upon boarding.

Please Remember

DART requires exact fares and all special IDs upon boarding.
All DART locations are smokefree pursuant to the Iowa Smokefree Air Act.
Transfer times are not guaranteed.

CUSTOMER SERVICE 515-283-8100

* Applies to adults 65+, persons with disabilities, refugees and students.

^ Applies to middle and high school students in Polk County with current school year ID. Student discount not valid with cash or tokens. Valid only on Local Express and Flex Routes.

May be asked for additional identification to validate use/sale of half-fares or passes. Contact DART Customer Service for more information about the Half Fare program.

Information found on this schedule can be provided in an alternative format upon request. Please contact Customer Service at 515-283-8100 to speak to a representative or email darr@dart.com. DART will do its best to provide the requested alternative format within a reasonable timeframe.

Des Moines Area Regional Transit Authority
620 Cherry Street, Des Moines, Iowa 50309
515-283-8100 ▶ ridedart.com



All Trips
Accessible

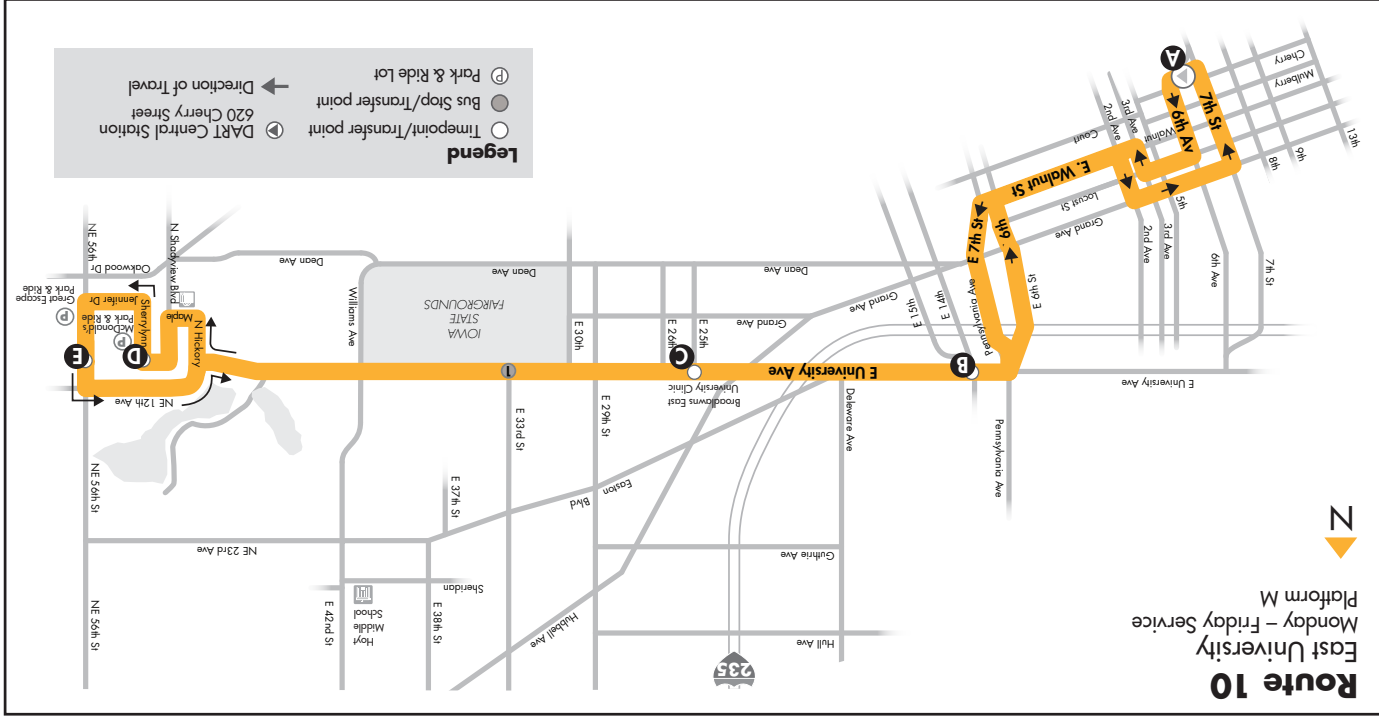

EASTBOUND-Outbound Monday-Friday

DART Central Station	E University & E 14th St	E University & E 25th St (Broadlawns)	Sherrilynn & E University Ave
A	B	C	D
6:00	6:11	6:15	6:25
6:30	6:41	6:45	6:55
7:30	7:41	7:45	7:55
8:30	8:41	8:45	8:55
9:30	9:41	9:45	9:55
10:30	10:41	10:45	10:55
11:30	11:41	11:45	11:55
12:30	12:41	12:45	12:55
1:30	1:41	1:45	1:55
2:30	2:41	2:45	2:55
3:30	3:41	3:45	3:55
4:30	4:41	4:45	4:55
5:30	5:41	5:45	5:55

WESTBOUND-Inbound Monday-Friday

Sherrilynn & E University Ave	NE 56th St & E University Ave	E University & E 25th St (Broadlawns)	E University & E 14th St	DART Central Station
D	E	C	B	A
5:26	5:28	5:37	5:41	5:53
5:56	5:58	6:07	6:11	6:23
6:30	6:32	6:41	6:45	6:57
6:56	6:58	7:07	7:11	7:23
7:56	7:58	8:07	8:11	8:23
8:56	8:58	9:07	9:11	9:23
9:56	9:58	10:07	10:11	10:23
10:56	10:58	11:07	11:11	11:23
11:56	11:58	12:07	12:11	12:23
12:56	12:58	1:07	1:11	1:23
1:56	1:58	2:07	2:11	2:23
2:56	2:58	3:07	3:11	3:23
3:56	3:58	4:07	4:11	4:23
4:56	4:58	5:07	5:11	5:23
5:56	5:58	6:07	6:11	6:23

► Weather, special events and traffic conditions may alter service.

Stay connected with DART
Download the MyDART app

Get detour and service updates

Follow @ridedart on Facebook, Twitter and Instagram

Plan trips, buy bus passes and get next bus times. Available on Android and iOS devices.

Sign up for email alerts at ridedart.com/email-updates